

Installing the imaging unit

1. Open the printer's front door to install the imaging unit.

Caution *Make sure that the right side door is closed to minimize light exposure; the imaging unit is extremely light-sensitive.*

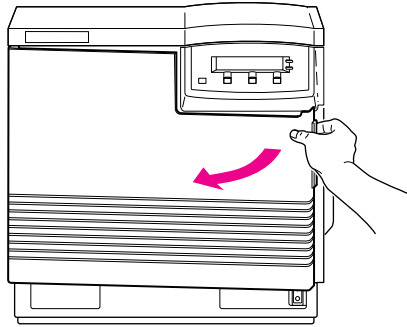

Caution *The imaging unit weighs approximately 5.9 kg (13 lbs.); always use the handles when lifting it.*

2. Remove the imaging unit from its box and plastic bag, but leave the protective plastic sheet on until immediately before you insert the unit into the printer.

Caution *The imaging unit is extremely light-sensitive; make sure that it is not exposed to light for more than 45 seconds or it may damage the unit. Never expose it to direct sunlight.*

Save all packing material in case you need to store the imaging unit or if you need to return it for repair or replacement.

3. On the imaging unit, turn the two outer blue knobs *clockwise* to align the triangles. (This tightens the internal belt to ready the unit for printing.)

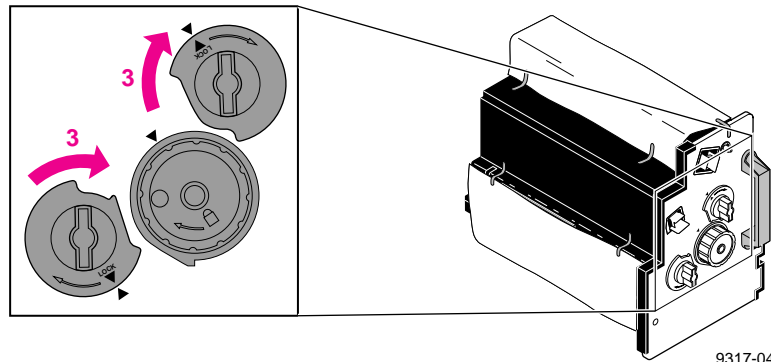

9317-04

4. Remove the adhesive tape from the protective plastic sheet; then remove the sheet from the imaging unit, taking care not to touch the green belt (right side) or the underside.
5. Insert the imaging unit into the printer, holding it by the blue handles. Release the left handle and slide the unit in until it stops.

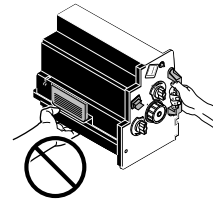
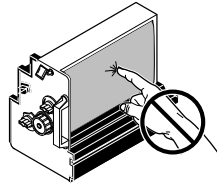
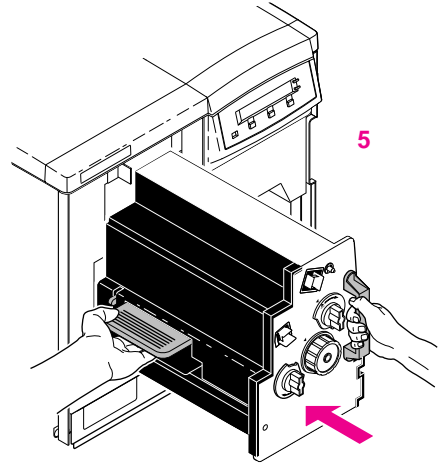
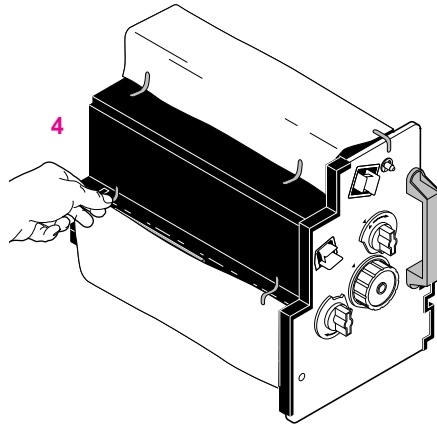

Caution Be sure the outer two blue knobs are aligned **vertically**. If the belt is not tight, it may catch on the printer cabinet during installation.

Be careful not to touch the green belt (the right side) or the underside of the imaging unit; fingerprints may affect the print quality. Keep the imaging unit's light exposure to a minimum (under 45 seconds), or you may damage the unit. Never expose it to direct sunlight.

6. Turn the center blue knob *clockwise* to insert the imaging unit completely and to lock it. The lock icon should align with the triangle.

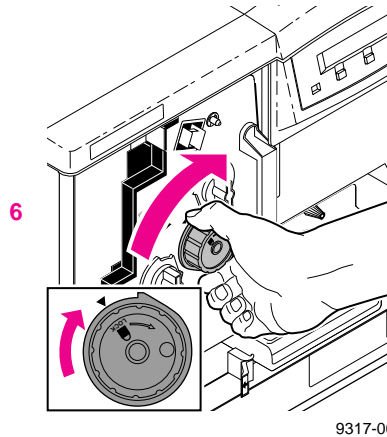

9317-06

7. Close the printer's front door.